



# PROPOSED WINNEY BAY CLIFFTOP WALK, 5 LANDS COASTAL WALKWAY - STAGE 5, CAPTAIN COOK LOOKOUT - WINNEY BAY

## AT COPACABANA, NSW FOR GOSFORD CITY COUNCIL A2 SERIES - GENERAL ARRANGEMENT PLANS



### LOCALITY PLAN

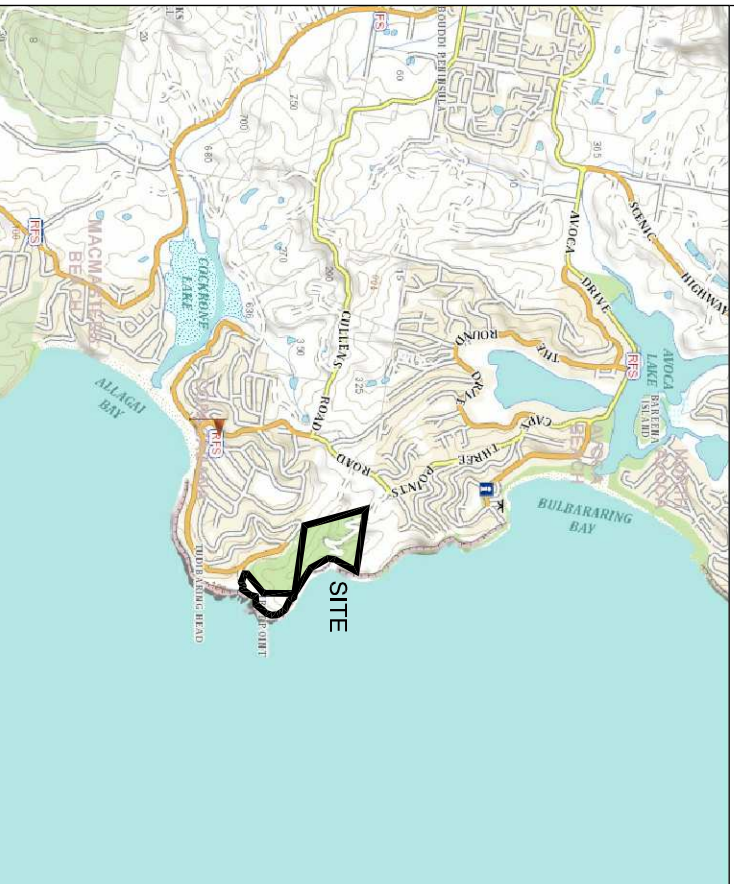

### GOSFORD CITY COUNCIL

- ALL WORK IS TO BE CARRIED OUT IN ACCORDANCE WITH GOSFORD CITY COUNCIL'S CIVIL CONSTRUCTION SPECIFICATION AND SUBDIVISION POLICY TO THE SATISFACTION OF THE DIRECTOR - DEVELOPMENT / ENVIRONMENT.
- ALL EROSION AND SEDIMENTATION CONTROL MEASURES ARE TO BE CARRIED OUT IN ACCORDANCE WITH COUNCIL'S CODE OF PRACTICE FOR EROSION AND SEDIMENTATION, AND MUST BE INSTALLED PRIOR TO ANY CONSTRUCTION OF CIVIL WORKS. THE DEVELOPER IS RESPONSIBLE FOR THE ONGOING MAINTENANCE OF EROSION AND SILTATION CONTROL MEASURES.
- ALL PUBLIC UTILITIES ARE TO BE CLEARLY IDENTIFIED IN THE FIELD PRIOR TO ANY CIVIL WORKS. COUNCIL ACCEPTS NO RESPONSIBILITY FOR DAMAGE OR RELOCATION COSTS TO UTILITIES DURING CONSTRUCTION.
- GOSFORD CITY COUNCIL IS TO BE NOTIFIED PRIOR TO THE COMMENCEMENT OF ANY WORKS - TELEPHONE NUMBER - 4925 8200.
- IT IS THE CONTRACTORS RESPONSIBILITY TO ENSURE THAT ALL WORKS ARE CARRIED OUT IN ACCORDANCE WITH THE OCCUPATIONAL HEALTH AND SAFETY ACT.
- PERMISSION TO ENTER, CONSTRUCT WORKS AND DISCHARGE STORM WATER ONTO ADJOINING PROPERTIES IS TO BE OBTAINED AND SUBMITTED TO COUNCIL PRIOR TO COMMENCEMENT OF ANY WORKS.
- PAVEMENT TO BE DESIGNED AND CERTIFIED BY A PRACTISING CONSULTANT GEOTECHNICAL ENGINEER AND SUBMITTED TO COUNCIL FOR APPROVAL PRIOR TO THE COMMENCEMENT OF ANY WORKS.
- ALL RECTIFICATION WORK ARISING FROM INSUFFICIENT INFORMATION BEING SHOWN IN THE SURVEY PLANS IS TO BE CARRIED OUT TO THE ENGINEER'S SATISFACTION.
- ALL DISTURBED AREAS TO BE SHAPED AND MULCHED, PLANTED WITH NATIVE PLANTS 1 PER 0.5m<sup>2</sup>.
- THE PLANS TO BE READ IN CONJUNCTION WITH ENGINEERING PLAN APPROVAL CORRESPONDENCE.

### EARTHWORKS

- WITHIN EXTENTS OF WORK AREA, STRIP ALL TOPSOIL & STOCKPILE FOR RE-USE OR DISPOSE. REMOVE ALL STRUCTURES & DEBRIS
- EXCAVATE, STOCKPILE OR DISPOSE OF MATERIAL TO EXPOSE SUB-GRADE AS SPECIFIED IN CUT AREAS.
- BENCH & PROOF ROLL IN ACCORDANCE WITH ASS3798 & PRESENT TO SUPERINTENDENT FOR APPROVAL.
- REPLACEMENT OF SUB-GRADE TO BE UNDERTAKEN ONLY AFTER INSTRUCTION FROM THE SUPERINTENDENT & TO THE EXTENT AS DIRECTED.
- COMPACT SUB-GRADE TO 100% STANDARD MAXIMUM DRY DENSITY AT OPTIMUM MOISTURE CONTENT ±2% OR TO 90% RELATIVE DENSITY AS MAY APPLY
- TESTING OF ALL COMPACTED LAYERS, INCLUDING SUB-GRADE TO BE ALLOWED FOR BY THE CONTRACTOR.
- FOR SAND SUB-GRADES, COMPACT TO DENSITY INDEX AS SPECIFIED IN THE DRAWING, REPORTS OR SUPERINTENDENT'S INSTRUCTION.
- ALL PAVEMENTS OR BUILDING PADS TO BE COMPACTED & TESTED IN ACCORDANCE WITH AS 1289, THE GEOTECHNICAL REPORT OR AS SPECIFIED ON THE DRAWINGS.

### GEOTECHNICAL

- GEOTECHNICAL INVESTIGATION PERFORMED BY:  
DOUGLAS PARTNERS  
REF: 94701.00 (APRIL 2015)
- ALL EARTHWORKS AND PAVEMENT WORKS TO BE EXECUTED AS DESCRIBED IN THE GEOTECHNICAL REPORT, AND AS DIRECTED BY THE GEOTECHNICAL ENGINEER.
- ANY RECOMMENDATIONS MADE IN THE GEOTECHNICAL REPORT SHALL OVERRIDE STANDARD REQUIREMENTS AS LISTED IN THESE DRAWINGS OR OTHER SPECIFICATIONS.
- TESTING AND INSPECTION OF DESIGN SUB-GRADE, PAVEMENT, BACKFILL AND ANY OTHER OPERATIONS SHALL BE IN ACCORDANCE WITH THE RELATIVE AUTHORITY SPECIFICATIONS AND THE COST OF SAME SHALL BE ALLOWED FOR BY THE CONTRACTOR.
- TEST PITS AND BORE LOGS ARE INDICATIVE ONLY AND ACTUAL SITE GROUND CONDITIONS MAY VARY. DEPTHS TO SOIL FROM THE LAYERS SUCH AS UNCONTROLLED FILL AND ROCK HAVE BEEN INTERPOLATED AND VOLUMES AS CALCULATED MAY VARY FROM ACTUAL CONSTRUCTION VOLUMES.

### PAVEMENT CONSTRUCTION

- EXPOSED SUBGRADE SHALL BE COMPACTED TO 100% STANDARD MAXIMUM DRY DENSITY AT OPTIMUM MOISTURE CONTENT ±2% OR AS 1289 5.1.1, UNLESS NOTED OTHERWISE IN GEOTECHNICAL REPORT
- BASE COURSE SHALL BE COMPACTED TO 98% MODIFIED MAXIMUM DRY DENSITY AT OPTIMUM MOISTURE CONTENT ±2% IN ACCORDANCE WITH AS 1289 5.1.1, UNLESS NOTED OTHERWISE IN GEOTECHNICAL REPORT
- EXACT EXTENT OF SELECT LAYER TO PAVEMENT TO BE DETERMINED BY GEOTECHNICAL ENGINEER UPON INSPECTION OF EXPOSED SUBGRADE
- ALL CONCRETE WORKS TO BE IN ACCORDANCE WITH AS 3600.
- CONCRETE SHALL BE MINIMUM 40MPa, TYPE A AND MAXIMUM AGGREGATE 20mm UNLESS NOTED OTHERWISE
- REINFORCEMENT TO BE INSTALLED AS SPECIFIED WITH MINIMUM 45mm COVER UNLESS NOTED OTHERWISE
- CONCRETE TO BE PLACED AND COMPACTED WITH MECHANICAL VIBRATORS, POURING/ROPPING OF CONCRETE FROM HEIGHTS GREATER THAN 1m IS NOT PERMISSIBLE.

### SURVEY

- SURVEY BY:  
BANNISTER AND HUNTER PTY LTD
- ORIGIN OF COORDINATES:  

PLN NO.	E	N	RL
19496	-	-	92.37
- ALL WORKS TO BE SET OUT BY A REGISTERED SURVEYOR
- ALL LEVELS SHOWN ARE TO AHD

### DRAWING LIST

- |       |   |
|-------|---|
| A2.01 | GENERAL ARRANGEMENT COVER SHEET & NOTES |
| A2.02 | GENERAL ARRANGEMENT PLAN SHEET 1 OF 3   |
| A2.03 | GENERAL ARRANGEMENT PLAN SHEET 2 OF 3   |
| A2.04 | GENERAL ARRANGEMENT PLAN SHEET 3 OF 3   |

### STORMWATER DRAINAGE

- ALL STORMWATER DRAINAGE TO BE IN ACCORDANCE WITH AS 3600.3 & GOSFORD CITY COUNCIL CIVIL SPECIFICATION & COUNCIL POLICIES

DO NOT SCALE DRAWINGS. VERIFY ALL DIMENSIONS ON SITE.



**RGH CONSULTING GROUP**  
Multi-discipline Engineering  
Newcastle Office: Shop 113, The Junction  
Village Centre, Kentrick Street,  
The Junction NSW 2291  
Ph 02 4962 4414

Postal Address: PO Box 1180, Gosford NSW 2250

Central Coast Office: Suite 35, The Avenue,  
Mt Penang  
Parklands, Karlong NSW 2250  
Ph 02 4340 1911 Fax 02 4340 1544

Newcastle Office: Shop 113, The Junction  
Village Centre, Kentrick Street,  
The Junction NSW 2291  
Ph 02 4962 4414

REVISION	DESCRIPTION	DATE	REVISION	DESCRIPTION	DATE
A	PRELIMINARY ISSUE TO QUANTITY SURVEYOR	05.08.15			
B	RE-ISSUE TO QUANTITY SURVEYOR	24.08.15			
C	90% ISSUE	29.06.15			
D	COUNCIL APPROVAL	19.08.15			

Postal Address: PO Box 1180, Gosford NSW 2250  
Central Coast Office: Suite 35, The Avenue,  
Mt Penang, Parklands, Karlong NSW 2250  
Ph 02 4340 1911 Fax 02 4340 1544  
Newcastle Office: Shop 113, The Junction  
Village Centre, Kentrick Street,  
The Junction NSW 2291  
Ph 02 4962 4414

**RGH CONSULTING GROUP**  
Multi-discipline Engineering



ADDRESS: WINNEY BAY RESERVE  
COPACABANA N.S.W.

PROJECT: 5 LANDS COASTAL WALKWAY - STAGE 5  
CAPTAIN COOK LOOKOUT TO WINNEY BAY

DRAWING TITLE: GENERAL ARRANGEMENT COVER SHEET & GENERAL NOTES

ANTHONY JOHN GRIFFITHS  
MIE AUST OPENING 2342830

SCALE: 1:100

DATE: JANUARY 2015

JOB NUMBER: 20140492

SHEET: A2.01

REV: D

DATE: 2014/04/92

SCALE: 1:100

DATE: JANUARY 2015

JOB NUMBER: 20140492

SHEET: A2.01

REV: D

DATE: 2014/04/92

CONCEPT PLANS  
NOT FOR CONSTRUCTION

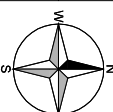





01 VIEW FACING NORTH-EAST AT THE PROPOSED LOCATION FOR THE WALKWAY BRIDGE CROSSOVER



02 VIEW FACING SOUTH-EAST AT THE PROPOSED LOCATION FOR THE WALKWAY BRIDGE CROSSOVER

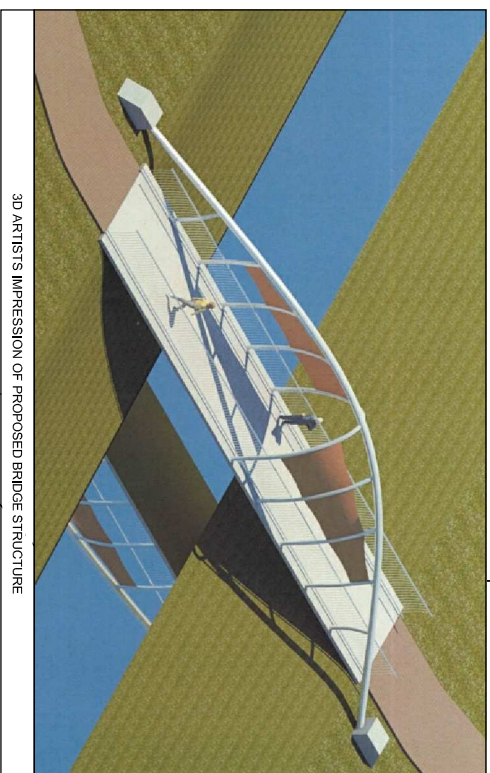

3D ARTIST'S IMPRESSION OF PROPOSED BRIDGE STRUCTURE



**CONCEPT PLANS  
NOT FOR CONSTRUCTION**

**GENERAL ARRANGEMENT DETAIL PLAN SHEET 1 OF 3**  
SCALE 1:500

LEGEND	
	SOUTH PACIFIC OCEAN
	LAND / GROUND (EXTENTS ARE INDICATIVE ONLY)
	PROPOSED WALKWAY/MARKET STALL PAVEMENT AREA (COLOUR TO BE CONFIRMED)
	DENOTES PROPOSED FOOTPATH LANDING IN ACCORDANCE WITH AS1428, TO TACTILE (TGS)
	DENOTES PROPOSED ELAVATED FOOTBRIDGE/FOOTPATH IN ACCORDANCE WITH AS1428
	PROPOSED SANDSTONE BLOCK RETAINING WALL
	PROPOSED HANDRAIL ALONG FOOTPATH ALIGNMENT
	INDICATES POSITION OF PHOTO / IMAGE
	PROPOSED BATTER, SLOPE VARIES, REFER TO TYPICAL PAVEMENT SECTIONS FOR BATTER SLOPES

REVISION	DESCRIPTION	DATE	REVISION	DESCRIPTION	DATE
A	PRELIMINARY ISSUE TO QUANTITY SURVEYOR	05.08.15			
B	RE-ISSUE TO QUANTITY SURVEYOR	24.08.15			
C	90% ISSUE	29.06.15			
D	COUNCIL APPROVAL	19.08.15			

**RGH CONSULTING GROUP**  
Multidisciplinary Engineering

Postal Address: PO Box 1180, Gosford NSW 2250  
Central Coast Office: Suite 35, The Avenue, Gosford NSW 2250  
Phone: 02 4340 1911 Fax: 02 4340 1944  
Marrumbidgee Office: Shop 111, The Junction, Valley Centre, Merimbula NSW  
Phone: 02 492 2415

FOR **GOSFORD CITY COUNCIL**  
CENTRAL COAST SPORT

**5 LANDS WALK**  
CENTRAL COAST - NEW SOUTH WALES

ADDRESS: WINNEY BAY RESERVE  
COPACABANA N.S.W.

PROJECT: 5 LANDS COASTAL WALKWAY - STAGE 5  
CAPTAIN COOK LOOKOUT TO WINNEY BAY

DRAWING TITLE: GENERAL ARRANGEMENT PLAN  
SHEET 1 OF 3

ANTHONY JOHN GRIFFITHS  
ME AUST OPENING 2342830

SCALE: 1:500 SHEET: A2.02

DATE: JANUARY 2015 REV: D

JOB NUMBER: 20140492

DATE: 20140492

A1



**LEGEND**

- SOUTH PACIFIC OCEAN
- LAND / GROUND (EXTENTS ARE INDICATIVE ONLY)
- PROPOSED WALKWAY/MARKET STALL PAVEMENT AREA (COLOUR TO BE CONFIRMED)
- DENOTES PROPOSED FOOTPATH LANDING IN ACCORDANCE WITH AS1428
- DENOTES PROPOSED ELEVATED FOOTBRIDGE/FOOTPATH IN ACCORDANCE WITH AS1428
- PROPOSED SANDSTONE BLOCK RETAINING WALL
- PROPOSED HANDRAIL ALONG FOOTPATH ALIGNMENT
- INDICATES POSITION OF PHOTO IMAGE
- PROPOSED BATTER, SLOPE VARIES, REFER TO TYPICAL PAVEMENT SECTIONS FOR BATTER SLOPES

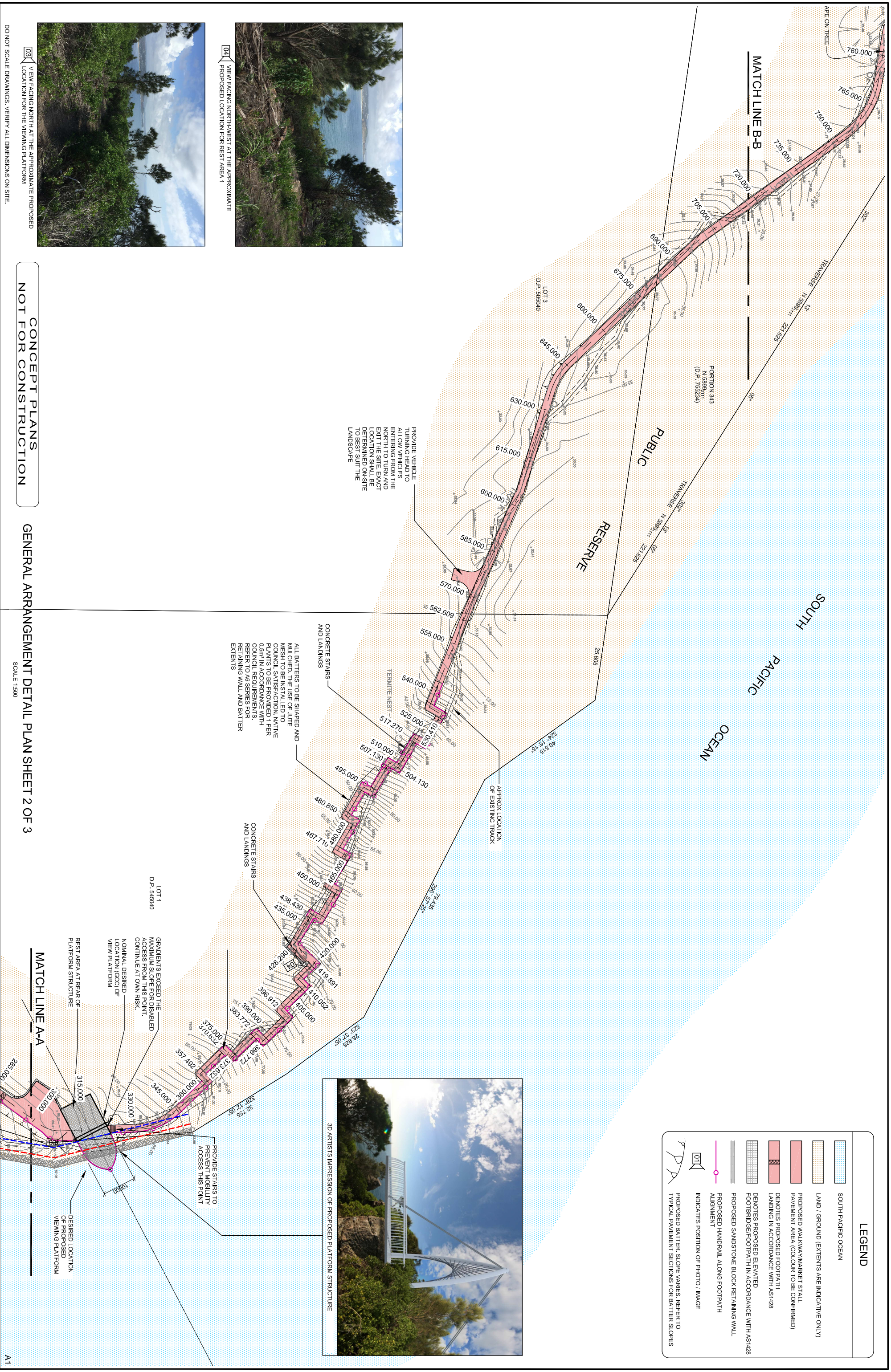

PROVIDE VEHICLE TURNING HEAD TO ALLOW VEHICLES ENTERING FROM THE NORTH TO TURN AND EXIT THE SITE. EXACT LOCATION SHALL BE DETERMINED ON-SITE TO BEST FIT THE LANDSCAPE

ALL BATTERS TO BE SHAPED AND MULCHED. THE USE OF LUTE MESH TO BE INSTALLED TO COUNCIL SATISFACTION. NATIVE PLANTS TO BE PROVIDED WITH 0.5m<sup>2</sup> IN ACCORDANCE WITH COUNCIL REQUIREMENTS. REFER TO A6 SERIES FOR RETAINING WALL AND BATTER EXTENTS

LOT 1  
D.P. 545940

GRADIENTS EXCEED THE MAXIMUM SLOPE FOR DISABLED ACCESS FROM THIS POINT. CONTINUE AT OWN RISK.  
NOMINAL DESIRED LOCATION (GCC) OF VIEW PLATFORM

REST AREA AT REAR OF PLATFORM STRUCTURE

MATCH LINE A-A

DESIRED LOCATION OF PROPOSED VIEWING PLATFORM



3D ARTIST'S IMPRESSION OF PROPOSED PLATFORM STRUCTURE



VIEW FACING NORTHWEST AT THE APPROXIMATE PROPOSED LOCATION FOR REST AREA 1



VIEW FACING NORTH AT THE APPROXIMATE PROPOSED LOCATION FOR THE VIEWING PLATFORM

DO NOT SCALE DRAWINGS. VERIFY ALL DIMENSIONS ON SITE.

CONCEPT PLANS  
NOT FOR CONSTRUCTION

GENERAL ARRANGEMENT DETAIL PLAN SHEET 2 OF 3  
SCALE 1:500

REVISION	DESCRIPTION	DATE	REVISION	DESCRIPTION	DATE
A	PRELIMINARY ISSUE TO QUANTITY SURVEYOR	05.08.15			
B	RE-ISSUE TO QUANTITY SURVEYOR	24.08.15			
C	90% ISSUE	29.08.15			
D	COUNCIL APPROVAL	19.08.15			

**RGH CONSULTING GROUP**  
Multidisciplinary Engineering

Postal Address: PO Box 1180, Gosford NSW 2250  
 General Office: Suite 35, The Avenue,  
 100 Princes Highway, Gosford NSW 2250  
 Ph: 02 4340 1911 Fax: 02 4340 1944  
 Murrumbidgee Office: Shop 113, The Junction  
 Valley Centre, Murrumbidgee NSW 2517  
 Ph: 02 492 2416

**GOSFORD CITY COUNCIL**  
CENTRAL SPORT

**5 LANDS WALK**  
CENTRAL COAST - NEW SOUTH WALES

ADDRESS: WINNEY BAY RESERVE  
COPACABANA N.S.W.

PROJECT: 5 LANDS COASTAL WALKWAY - STAGE 5  
CAPTAIN COOK LOOKOUT TO WINNEY BAY

DRAWING TITLE: GENERAL ARRANGEMENT PLAN  
SHEET 2 OF 3

ANTHONY JOHN GRIFFITHS  
ME AUST OPENING 2342830

SCALE	DATE	BY	CHECKED	DATE	JOB NUMBER
1:500		JSG/W	AS	JANUARY 2015	20140492

SHEET: **A2.03**

REV: **D**

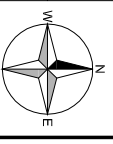

A1



LEGEND	
	SOUTH PACIFIC OCEAN
	LAND / GROUND (EXTENTS ARE INDICATIVE ONLY)
	PROPOSED WALKWAY/MARKET STALL PAVEMENT AREA (COLOUR TO BE CONFIRMED)
	DENOTES PROPOSED FOOTPATH
	LANDING IN ACCORDANCE WITH AS1428
	DENOTES PROPOSED ELEVATED FOOTBRIDGE/FOOTPATH IN ACCORDANCE WITH AS1428
	PROPOSED SANDSTONE BLOCK RETAINING WALL
	PROPOSED HANDRAIL ALONG FOOTPATH ALIGNMENT
	INDICATES POSITION OF PHOTO / IMAGE
	PROPOSED BATTER: SLOPE VARIES, REFER TO TYPICAL PAVEMENT SECTIONS FOR BATTER SLOPES

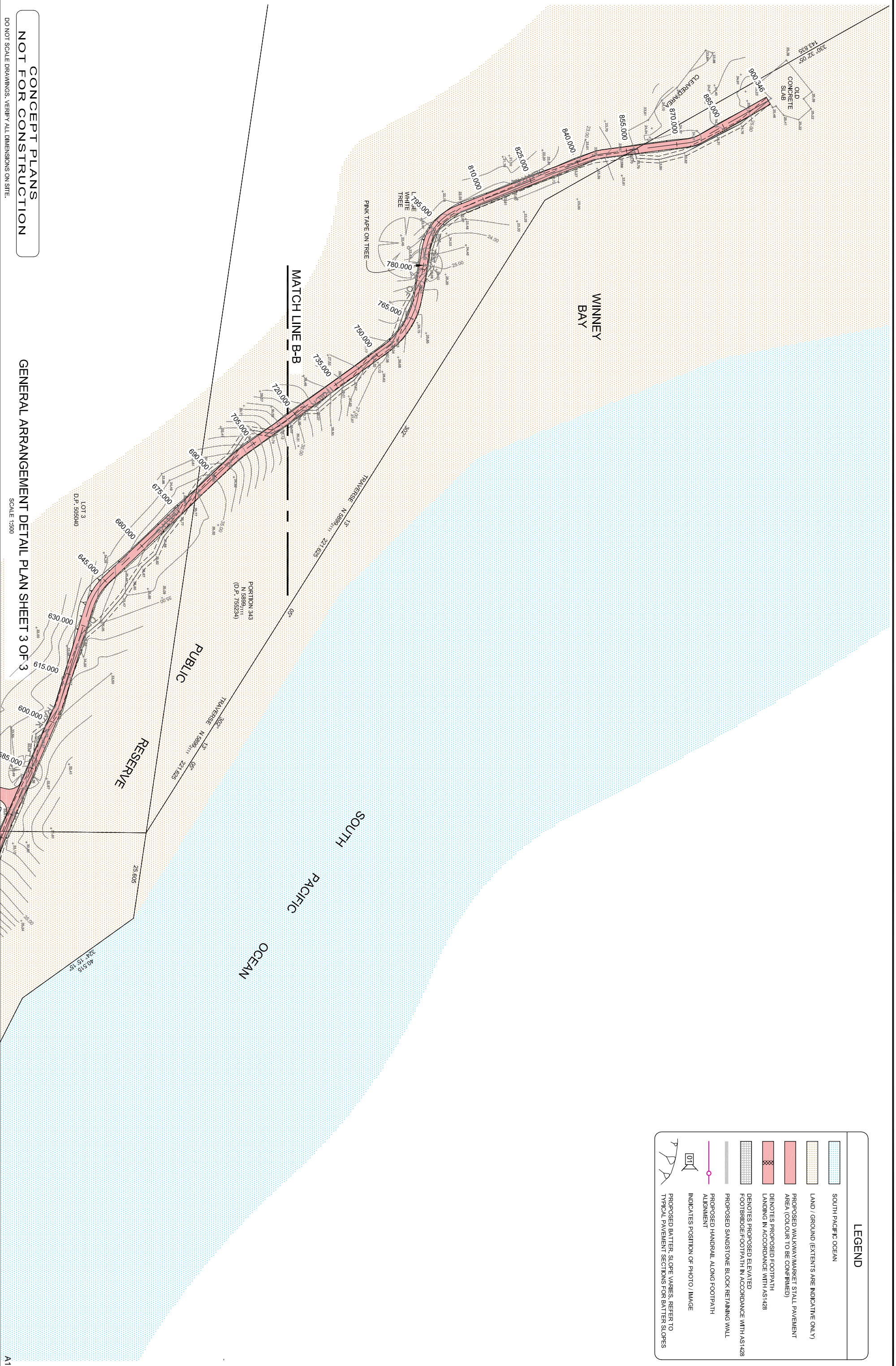

**CONCEPT PLANS**  
**NOT FOR CONSTRUCTION**

**GENERAL ARRANGEMENT DETAIL PLAN SHEET 3 OF 3**  
SCALE 1:500

REVISION	DESCRIPTION	DATE
A	PRELIMINARY ISSUE TO QUANTITY SURVEYOR	05.08.15
B	RE-ISSUE TO QUANTITY SURVEYOR	21.08.15
C	90% ISSUE	29.08.15
D	COUNCIL APPROVAL	19.09.15

**RGH CONSULTING GROUP**  
Multidisciplinary Engineering

Postal Address: PO Box 1180, Gosford NSW 2250  
 General Office: Suite 35, The Avenue,  
 The Junction, Gosford NSW 2250  
 Phone: 4340 1911 Fax: 4340 1944  
 Murrumbidgee Office: Shop 111, The Junction,  
 The Junction NSW 2291  
 Phone: 492 2419

**GOSFORD CITY COUNCIL**  
CENTRAL SPORT

**5 LANDS WALK**  
CENTRAL COAST - NEW SOUTH WALES

ADDRESS: WINNEY BAY RESERVE  
COPACABANA N.S.W.

PROJECT: 5 LANDS COASTAL WALKWAY - STAGE 5  
CAPTAIN COOK LOOKOUT TO WINNEY BAY

DRAWING TITLE: GENERAL ARRANGEMENT PLAN  
SHEET 3 OF 3

ANTHONY JOHN GRIFFITHS  
ME AUST OPENING 2342830

SCALE	SHEET
1:500	A2.04
BRAIN	JC/W
DESIGNED	CF
CHECKED	AJS
DATE	JANUARY 2015
JOB NUMBER	20140402
	D

